

# PROCLAIM

**Peace Church**  
From then to Now



# OUR HISTORY



Nearly 60 years ago, a pioneering group of believers set out on an adventure to fulfill God's great commission in a new place.



South East Area Reformed Church was planted south of Grand Rapids in the mid-60s by a group of believers. The name was changed to Peace Reformed Church in 1965 when the church officially launched.

# INTENTIONAL DISCIPLESHIP



## Kids & Students

Investing in and discipling our kids and students alongside parents is a priority at Peace Church. Our Programs for children on Sunday mornings and Wednesday Nights and Students on Sunday nights have consistently grown in recent years.

**Sunday Morning (0-3rd Grade):** 320 Kids

**Wednesday Nights (1st - 5th Grade):** 293 Kids

**Sunday Nights (6th-12th Grade):** 230 Students



## Men's & Women's Ministry

The goal of our Men's and Women's ministries is to provide a place to equip and encourage men and women to continue to build their relationship with Jesus.

Our Men's & Women's Bible Studies meet regularly and have consistent, growing attendance.

**Men's Bible Study:** 100 Weekly

**Women's Bible Study:** 200+ Weekly



## Friends @ Peace

Friends at Peace has provided an uplifting evening for adults who have special needs where we pray for each other, hear the Bible read, and enjoy each other's company!

We also enjoy hearing them worship during one of our special Friends at Peace Sundays each year.

**Friends at Peace:** 20 Friends & 17 Mentors

# COMMUNITY



## Community Outreach

Our heart is to invest not just in our own church community, but in our local and global communities.

This includes our supported missionaries, community groups for all walks of life, and outreach events.

**Community Groups:** 340 People across 35 groups.



## Baptisms

Write something about baptism

**Infant Baptisms:** 48 children

**Adults Baptisms:** 24 Adults

**Profession of Faith:** 43 Adults & Students



## Staff

Write something about staff

**Staff Members:** 39 Adults + 7 Students

# THE LAST 5 YEARS OF GROWTH



**Attendance from 2018-2019**  
**822 Average Sunday Attendance**  
2 Services

**Attendance from 2022-2023**  
**1883 Average Sunday Attendance**  
3 Services



# DRASTIC GROWTH

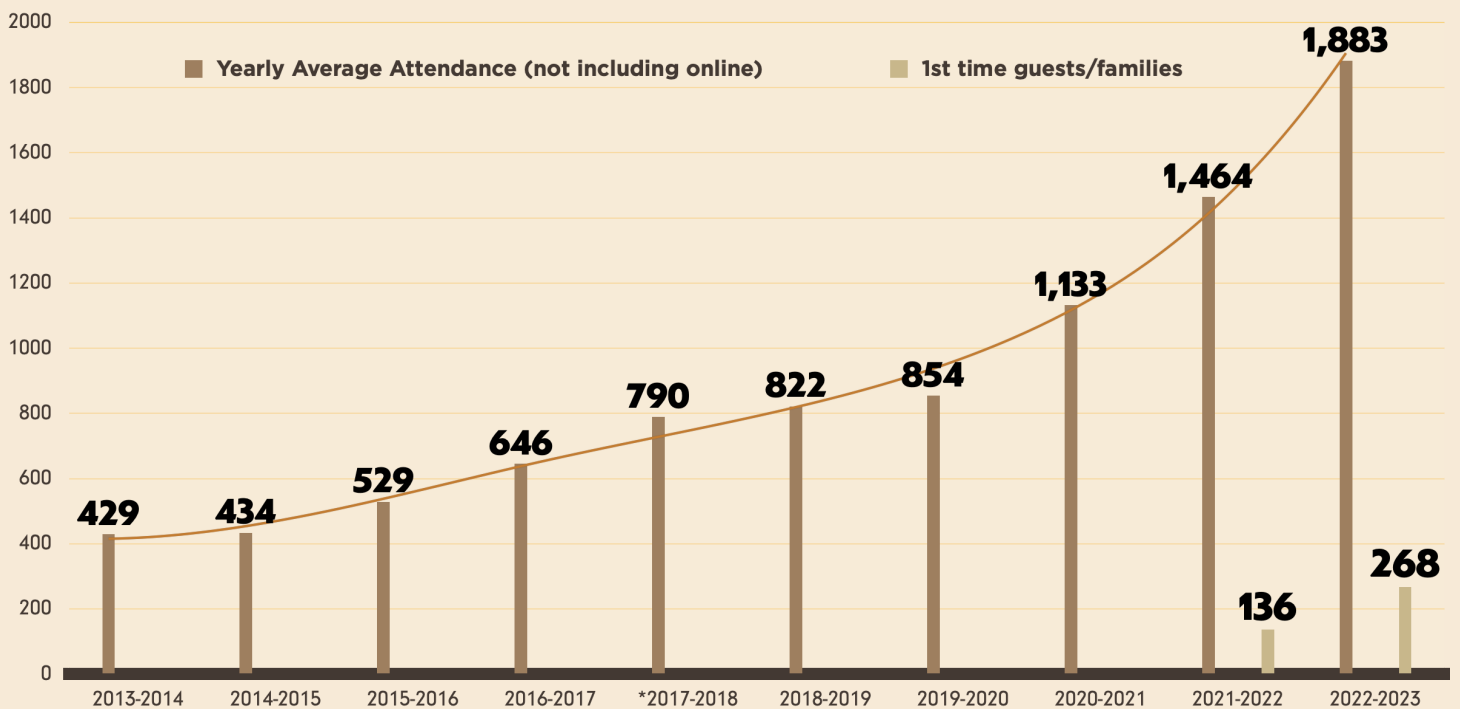

Our attendance has grown each year for the last 10 years. Our largest jumps came between 2016-2017 & 2017-2018 years and from 2020-2021 onward. We also now track new families, with 268 new families attending Peace Church for the first time in 2022-2023.

# THE NEED



**2000 People + 600 Seat  
Worship Center =  
Uninviting & Exclusive**

**2000 People + 2700 Sq. Ft  
Lobby = Congested &  
Overcrowded**

**345 Parking Spots =  
Limiting & Frustrating**



# OPTIONS

1

## **More Service Times**

Earlier or Later Service times are not appealing or favorable.

2

## **More Campuses**

This is a vision of Peace Church, but only as an outreach strategy. More campuses is not a growth strategy.

3

## **More On-Campus Venues**

Multiple attempts show that people want to watch the service live in the Worship Center.



# THE VISION



# PROCLAIM

## Following God's Call

Take our church through "Proclaim!," a fall spiritual journey and capital campaign to raise the finances to expand our facility and to spiritually prepare our church for increased ministry.

# THE PLAN



- Double the Worship Center size.
- Enlarge the Lobby space.
- Increase the Parking Lot size and number of spaces.



# THE PLAN



**View from the right of our  
current Main Entrance**



**View from Cherry Valley Rd,**

# THE PLAN



**Future Lobby Space**



**Future Worship Center will be warm, inviting, and have natural light.**

# THE PLAN

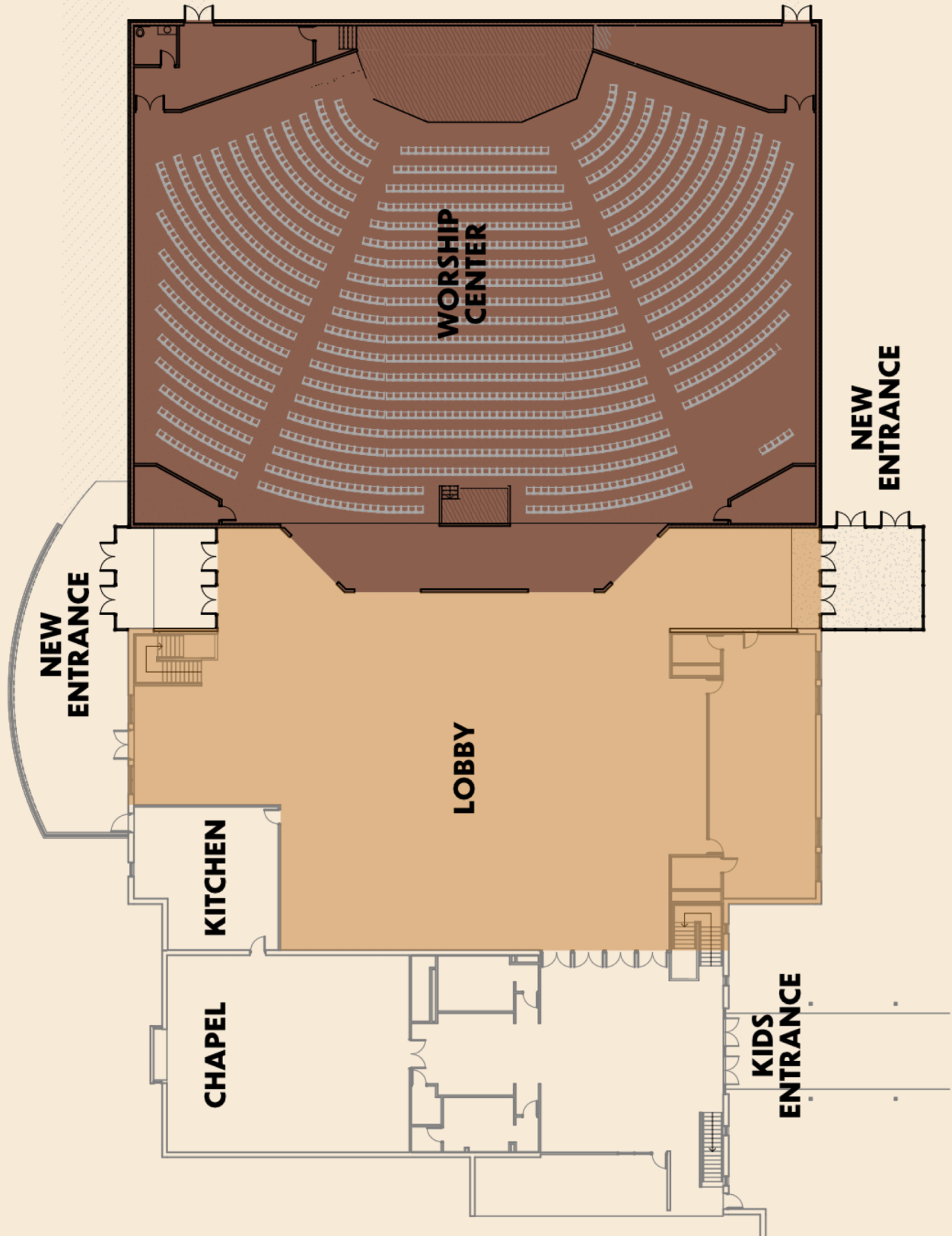

Worship Center | 1200 seats and 13,600 Sq. Ft  
Lobby | 8100 Sq. Ft

# THE PLAN

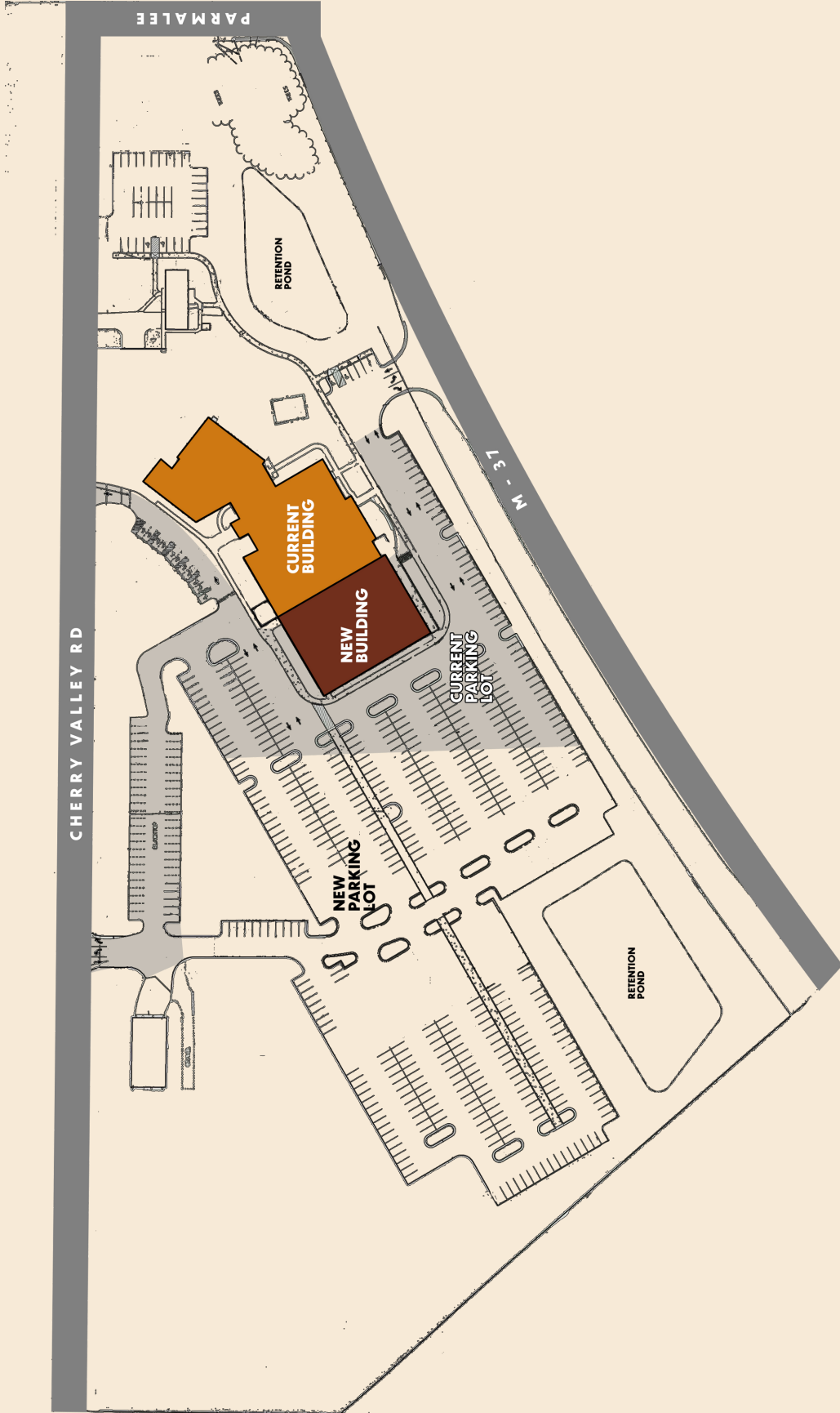

# THE WHY

1

Respond to what God is already doing.

2

Reach more people for Christ.

3

Partnering to bolster our Ministry.

4

Leaving a building that the next generation will use to bring the Gospel into the future.

5

Proclaim the Gospel without limits.

# THE HOW

8

# Million Dollars

**The Budget and Projected Cost is 8  
Million Dollars.**

**5.5 for Construction and 2.5 for Site  
Work**



**Our Campaign Consultants believe we can raise between 1.5 and 3.5 Million  
Dollars. Our prayer is to raise 2.5 Million Dollars.**



# WHAT'S NEXT

1

## Proclaim!

This Spiritual journey will last from October 6 - November 5, 2023.

2

## Site Work

Site work could begin as soon as November 2023

3

## Building Project Completion

Early: Easter 2025

Target: Fall Launch 2025

Late: Christmas 2025

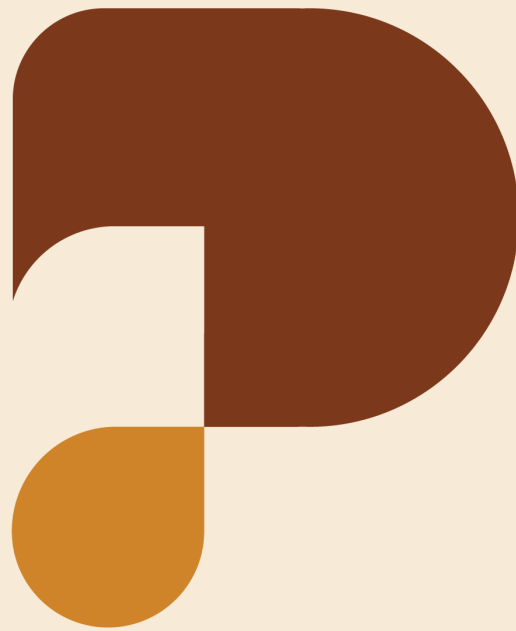

# PROCLAIM

Following God's Call

